



# EXISTING and PROPOSED NAMES

OLD BRISBANE BOTANIC GARDENS

by Jeannie Sim

Extracted from 2005 Review

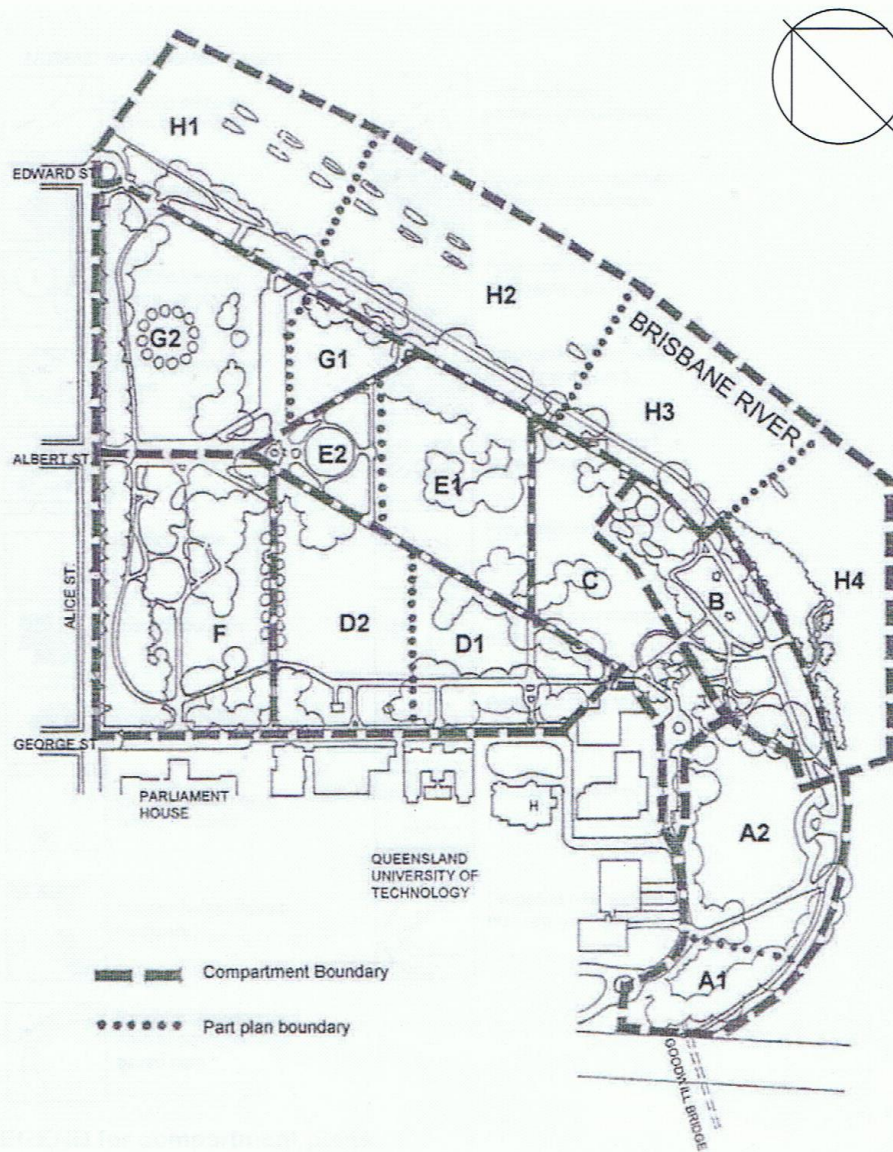

Part of the Conservation Study in 1995 included designating areas for management : hence A-H.

But in 2005, I went further and went naming things!

**PROPOSED NAMES!**

Sim 2005:36

Figure 3.1 PLAN OF ALL GARDEN COMPARTMENTS

# Appendix B

## Naming components

Entry NAME	LOCATION / compartment	Existing	PROPOSED → reason
EDWARD ST ENTRY	Bus terminus at end of Edward St	G+H	Yes
MAIN ENTRY	Alice Street, opposite Albert Street	F+G	Yes
GEORGE ST ENTRY	Opposite Parliament House	F	Yes
Pinetum Entry	Opposite A Block (QUT)	D+F	Proposed in 1999 → near Conifer Garden
Knoll Entry	Opposite B Block (QUT)	D	Proposed in 1999 → on highest point on site
Banyan Entry	Opposite U Block (QUT)	D	Proposed in 1999 → near 2 figs
Governor's Entry	Opposite Old Government House	D	Proposed in 1999 as OGH Entry
GARDENER'S GATE	Adjacent Gardens Theatre (QUT)	D	Yes
GARDENS POINT	Back of amphitheatre near Toilets	B	Yes
ROAD ENTRY			Original to 1860s
Depot Entry	Back of Riverstage	A	Yes (?)
Path NAME	LOCATION / compartment	Existing	PROPOSED → reason
East Wing	Short link off Entry concourse	F	YES → really northeast
West Wing	Short link off Entry concourse	G	YES → really southwest
Royal Walk	Near Alice St (NE Queens Park)	G	YES → near Royal Palms & in Queens Park
People's Walk	Near Alice St (SW Queens Park)	F	YES → near Qld Parliament House
George's Way	From George St Entry to Lagoon	F	YES → from Street
Alice's Way	NW side of Lagoons	F	YES → near Alice Street
Lagoon Walk	SE side of Lagoons	F	YES → Links Entry Concourse & George's Way
Lagerstroemia Lane	Winding off and back Lagoon Walk	F	YES → through a Crepe Myrtle woodland
Pinetum Path	Links Alice's Way to Palm Avenue	F	YES → conifer collection in both sides
Rockery Track	Internal to Rockery plantation	F	YES → rough mulched trail
BUNYA WALK	Upper riverside path	H	Yes (1987) Single row of Bunya Pines (1860s)
RIVERWALK	Lower path beside river	H	Yes (1995) So named by JCRS in precious study.
MANGROVE	Through the Mangrove Forest	H	Yes (1980s) So named by John Daly, its creator
BOARDWALK			
HILL'S AVENUE	Between 2 rows of Weeping Figs	G	Yes (1987) But planted by Head Gardener Pink
Children's Trail	New paved path from new shelter shed to end of Hill's Avenue	G	YES → near Children's Playground
Queen's Row	From Information Rotunda to Bunya Walk	G	YES → near Salvaged Colvilleas from Queen's Gardens
Flower Lane	Links Queen's Row and Central Path	G	YES → near Formal Flower Garden
PALM AVENUE	From Information Rotunda to Clay Border Path	F	Yes (1890s) Curator McMahon's creation in grass; paved 1987
CENTRAL PATH	From Information Rotunda to Former Curator's House	D+E	Yes (1995) So named by JCRS in precious study.
BAMBOO AVENUE	Part of Central Path	D+E	Yes
CLAY BORDER PATH	Parallel to QUT boundary	D	Yes (1890s) Clay soil; location of former ribbon borders
Coconut Alley	Links Camellia Garden with Flower Lane	E	YES → PROPOSED NEW PATH: lined with useful palms (oil, sago, coconuts, etc.)
Camellia Lane	Links Camellia Garden with Central Path	E	YES → PROPOSED NEW PATH:
Fountain Walk	Parallel to Central Path	E	YES → PROPOSED NEW PATH: near Walter Hill Drinking Fountain
Island Way	Links Central Path to Fountain Walk	E	YES → PROPOSED NEW PATH: includes crossing bridges to Fern Island
Azalea Lane	Links Central Path to Fountain Walk	E	YES → PROPOSED NEW PATH: south of Fern Island; near Azalea bed
Shady Lane	Links Camellia Garden to start of Curator's Avenue	E	YES → PROPOSED NEW PATH: fun name
Kiosk Lane	Links Camellia Garden to middle of Curator's Avenue	E	YES → PROPOSED NEW PATH: refers to former 2 <sup>nd</sup> kiosk (where Camellia Garden now resides)
The Amble	Links Central Path and Clay Border Path amid the Palm Garden	D	YES → NEW PATH: reinstating Oakman pathway removed in 1987
CURATOR'S AVENUE	Links Bunya Walk and Central Path	E+C	Yes (1990s) Planting post 1987, pre-1995 study
Mango Lane	Links Curator's Ave and Governors' Entry	D	YES → near Hill where Mangoes grew; more planting proposed nearer palms
Gardener's Lane	Links Gardeners' Gate and Clay Border Path	D	YES → refers to long standing gate name

Specifically, I proposed names for all entries, paths (existing and proposed), and certain spaces.

Sim 2005:87

Path NAME cont.	LOCATION / compartment	Existing	PROPOSED → reason
Macadamia Trail	Rough track between Bunya Walk & Rainforest Track	B	YES → Leads to old Macadamia tree
Rainforest Track	Main track in Rainforest Garden	B	YES → Middle of Rainforest Garden
Rocky Road	Internal Rainforest Garden pathway	B	YES → lots of stone retaining edges
Curators' Stairs	From Former Curator's House to Rainforest Garden	B	YES → visible in 1870s photos
The Labyrinth	Internal Rainforest Garden pathway complex, behind Nursery	B	YES → winding paths too numerous to name individually!
The Verge	Edges Former Curator's House Front	C	YES → top of the hill
North Path	In front of Former Curator's House	C	YES → created in 1987 redevelopment
West Path	Beside Former Curator's House	C	YES → created in 1987 redevelopment
East Path	Beside Former Curator's House	C	YES → created in 1987 redevelopment
South Path	Behind Former Curator's House	C	YES → created in 1987 redevelopment
Space NAME	LOCATION / compartment	Existing	PROPOSED → reason
Queen's Park Field	Northeast end, near Alice St	G	YES → athletic field of FORMER QUEEN'S PK
CIRCLE of ROYAL PALMS	Royal palms in Queens Park Field	G yes	Or PALM CIRCLE
Tropicalian Woodland	Southeast side of Queens Park Field	G	YES → many exotic looking trees and lush grassland, potential for enriching character
Tropicalian shrubbery	Bordering bed to northeast of Queens Park Field	G	YES → previously excellent tropical shrubs & herbaceous display
BALDWIN LAWN	Southeast of Hill's Avenue	G Yes (1950s)	Proposed Tropical Fruit Orchard
Conifer Garden	North side of Palm Avenue	F	YES → existing collection
Pinetum	Nearest QUT entry off George Street	F	YES → lots of pines here <i>Hill named it 1856</i>
Rockery	Rockwork, planting, waterfall, & stream into Oakman's [top] Lagoon	F Yes	Part of Harry Oakman's 1960s scheme
OAKMAN'S LAGOON	Upper water body	F Yes (1995)	YES → he designed it
BICK'S LAGOON	Lower water body	F Yes (1995)	YES → [he designed it] <i>to be confirmed.</i>
Bamboo Lawn	Beside Bick's Lagoon	F Yes (sort of)	Instead of 'Back of Bamboo Lawn'
Bamboo Nook	Alice St/George St corner	F	YES → beside huge Golden Bamboo clump
Middle Flats	Lawn SE of Formal Flower Garden	E	YES → Part of oldest & middle section of place
Middle Woodland	Woody plantation near Bunya Walk	E	YES → Part of oldest & middle section of place
Middle Lowland	Lowest area, near Former Fern Island	E	YES → Part of oldest & middle section of place
New FERN ISLAND	Adjacent Central Path	E Yes	Removed in 1930s; PROPOSED NEW PLACE
BAMBOO GROVE	Surrounding Former Fern Island	E Yes	Replanting begun 1998
Economic Garden	SE side of Flower Lane	E	YES → NEW BORDER
Soundshell Hill	Large open space between Central Path and Clay Border Path	D Yes	Since 1950s-1987; 'Former Soundshell Hill' used in 1995 study
College Close	Between QUT boundary and Clay Border Path, near A block	D	YES → refers to Brisbane Central Technical College (precursor to QUT)
The Knoll	Between QUT boundary and Clay Border Path, near B block	D	YES → highest rise on site, good outlook <i>Dennis Gibson</i>
Scholar's Fig Grove	Opposite U Block	D	YES → mention made by Vice-Chancellor in 1998 opening of Main Driveway
Governor Bowen's Lawn	NW side of Governor's Entry (QUT boundary)	D	YES → refers to first Governor of Qld
Lady Bowen's Lawn	SE side of Governor's Entry (QUT boundary)	D	YES → refers to his wife and to Lady Bowen's Creeper ( <i>Pyrostegia ignea</i> )
LILY GARDEN	Borders Gardener's Lane	D Yes (2000)	
RESIDENCE HILL	North slope from Curator's House	C Yes	
HIBISCUS GARDEN	Near Curator's Avenue	C Yes	Relocated c.1993 from Camellia Garden site
Oak Lawn	Behind Lily Pond, near Bunya Walk	C	YES → Oaks planted here since 1860s
Lily Pond	Edge of Residence Hill & Rainforest	C Yes (1995)	
Lotus Pond	Edge of Residence Hill & Rainforest	C Yes (1995)	
Morning Star Lawn		F Yes	Booking site #1
Wedding Lawn		F Yes	Booking site #2
Lilypond Lawn (sic)		?C Yes	Booking site #3 – should be Lilypond Lawn
Entrance Lawn		G Yes	Booking site #4
Royal Palm Lawn		G Yes	Booking site #5
Formal Gardens		E Yes	Booking site #6
Rainforest Hideaway	Near First Bandstand	B Yes	Booking site #7
Café Outlook	Near Former Curator's House	C Yes	Booking site #8
Cordylina Lawn		D Yes	Booking site #9
Northern Stairs	Closest to Edward St Entry	H Yes (1995)	So named by JCRS in precious study.
Middle Stairs	Near Curator's Avenue	H Yes (1995)	So named by JCRS in precious study.
Southern Stairs	Near Rainforest Garden	H Yes (1995)	So named by JCRS in precious study.
Entry Concourse	Off Main entry, Alice St	F-G Yes (1987)	

To small to see here on screen, let's look more closely with a plan or two!

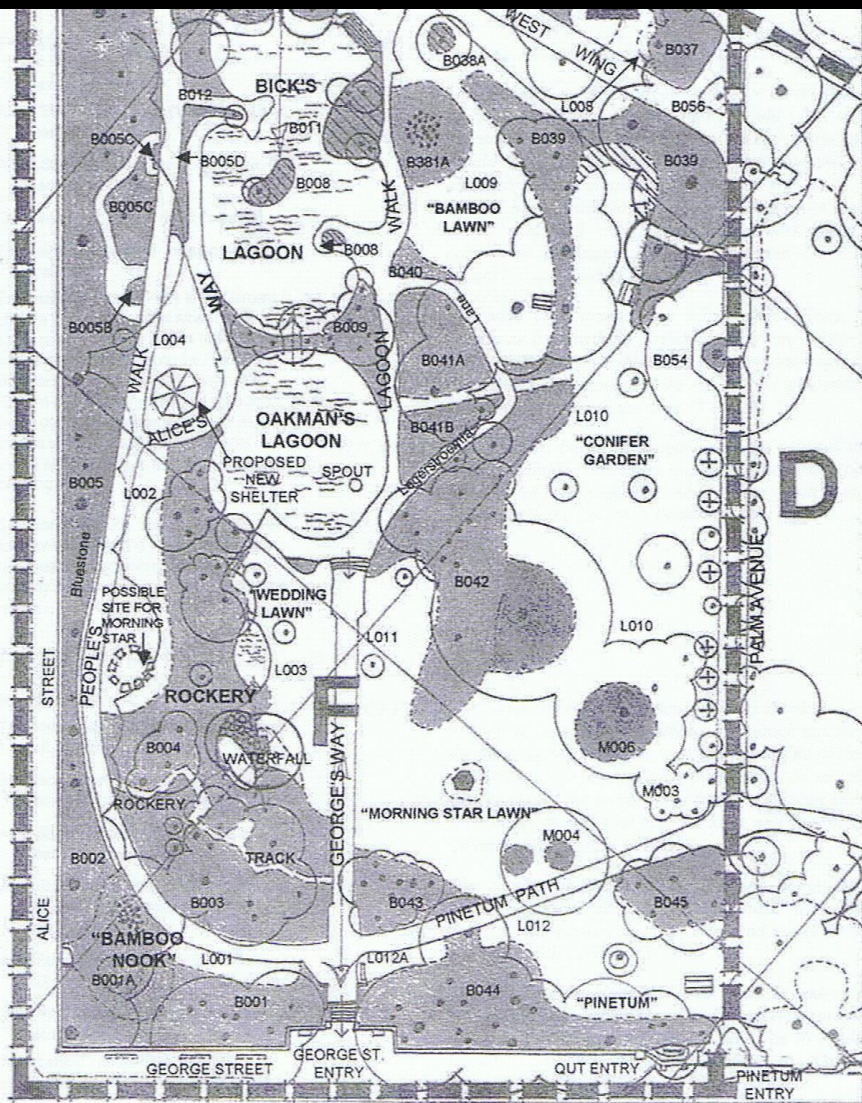

0 10 20 30 40 50m

Scale 1:1000

Refer to Legend for Compartment plans on page 40.

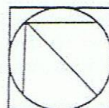

East Wing	Short link off Entry concourse	G
West Wing	Short link off Entry concourse	F
People's Walk	Near ( Park)	F
George's Way	From George St Entry to Lagoon	F
Alice's Way	NW side of Lagoons	F
Lagoon Walk	SE side of Lagoons	F
Lagerstroemia Lane	Winding off and back Lagoon Walk	F
Pinetum Path	Links Alice's Way to Palm Avenue	F
Rockery Track	Internal to Rockery plantation	F

Figure 3.10 PLAN of COMPARTMENT F: Lagoons & Surrounds

Sim 2005:63

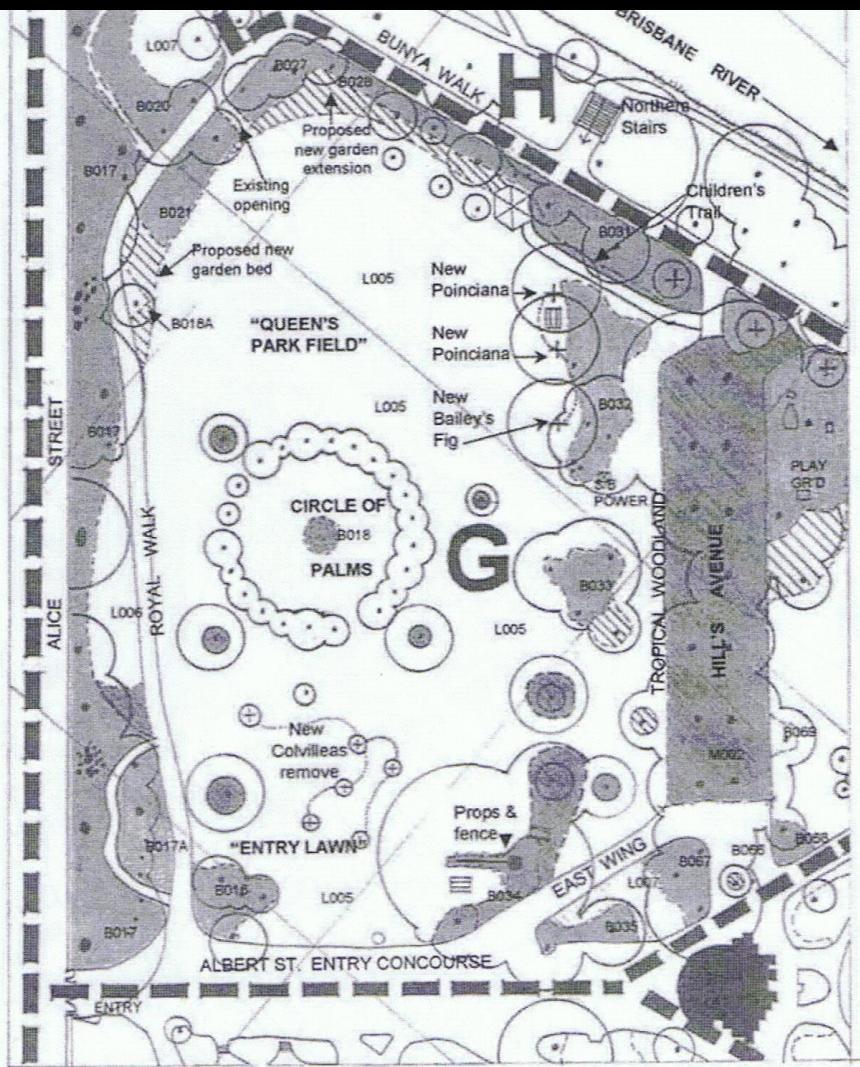

0 10 20 30 40 50m

Scale 1:1000 Refer to Legend for Compartment plans on page 40.

Scale 1:1000

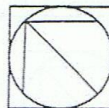
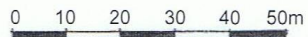
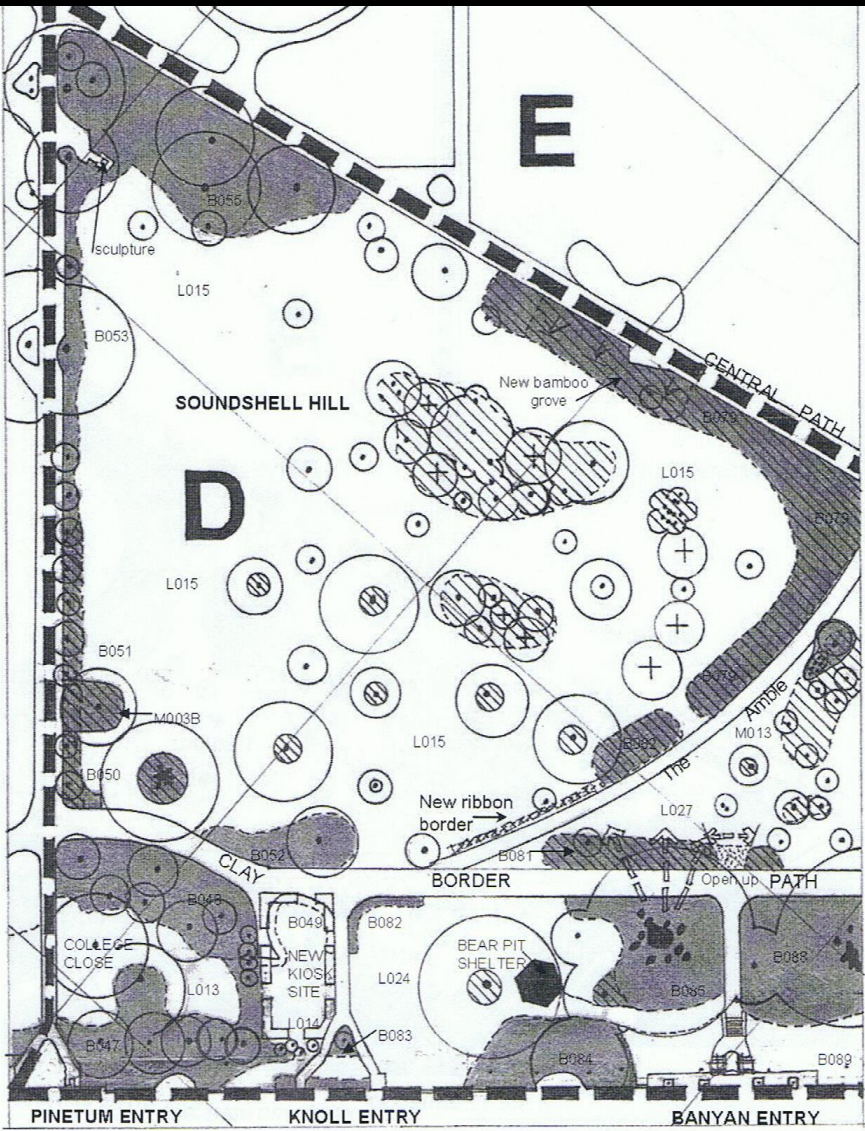

Figure 3.11 PLAN of COMPARTMENT G: Northern areas – Part 1 of 2

HILL'S AVENUE	Between 2 rows of Weeping Figs	G
East Wing	Short link off Entry concourse	G
Children's Trail	New paved path from new shelter shed to end of Hill's Avenue	G
Queen's Row	From Information Rotunda to Bunya Walk	G
Flower Lane	Links Queen's Row and Central Path	G
Royal Walk	Near ( Park)	G

Sim 2005:69



Scale 1:1000

Refer to Legend for Compartment plans on page 40.

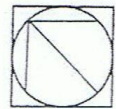
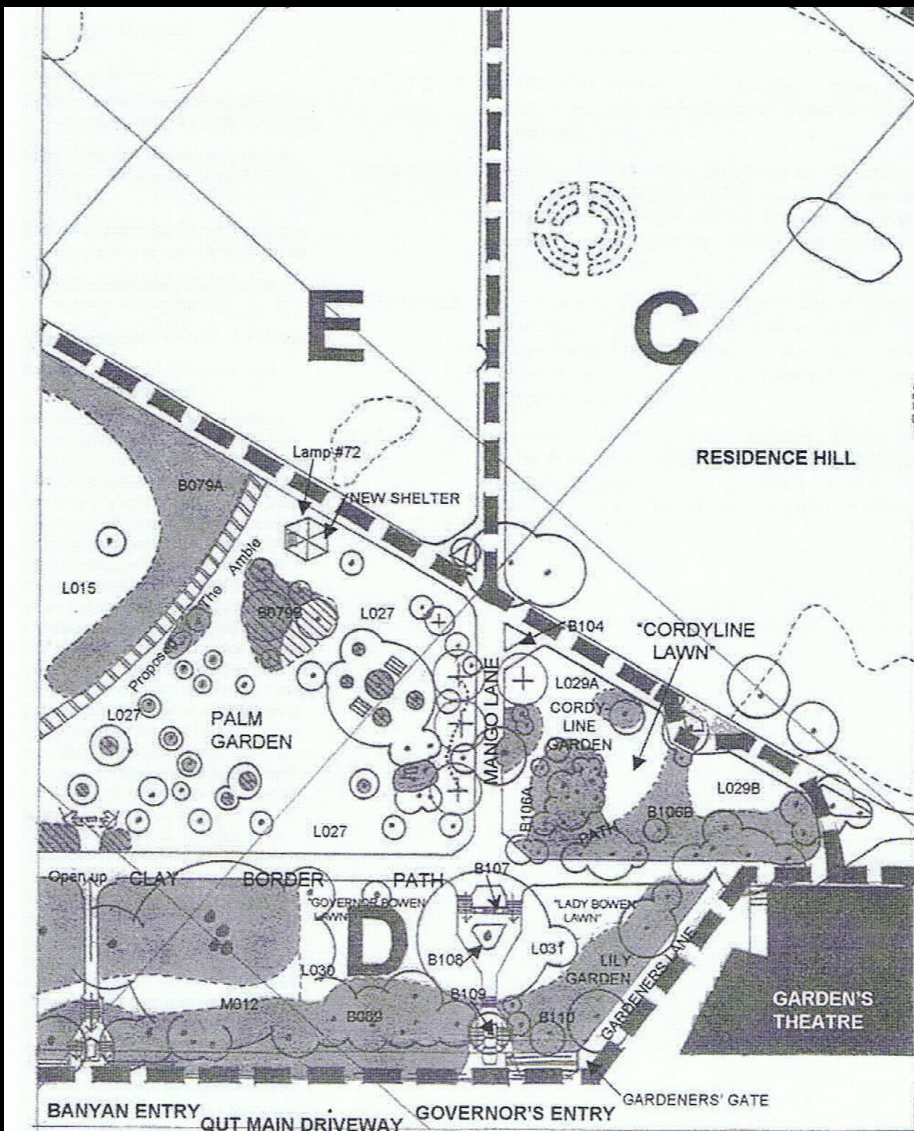

Figure 3.6 PLAN of COMPARTMENT D: Western areas – Part 1 of 2

The Amble	Links Central Path and Clay Border Path amid the Palm Garden	D
CURATOR'S AVENUE	Links Bunya Walk and Central Path	E+ C
Mango Lane	Links Curator's Ave and Governors' Entry	D
Gardener's Lane	Links Gardeners' Gate and Clay Border Path	D

Sim 2005:51



The Amble Links Central Path and Clay Border Path amid the Palm Garden D

CURATOR'S AVENUE Links Bunya Walk and Central Path E+ C

Mango Lane Links Curator's Ave and Governors' Entry D

Gardener's Lane Links Gardeners' Gate and Clay Border Path D

0 10 20 30 40 50m

Scale 1:1000

Refer to Legend for Compartment plans on page 40.

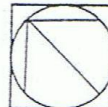

Sim 2005:52



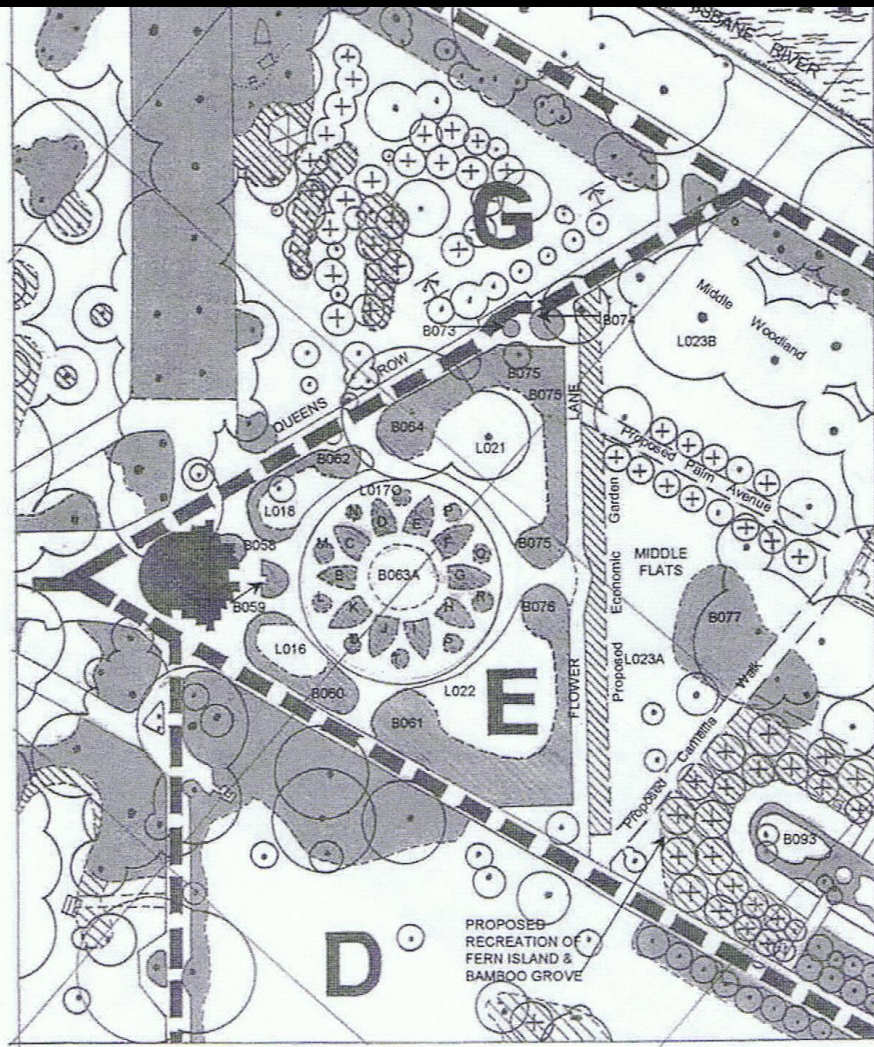

Coconut Alley	Links Camellia Garden with Flower Lane	E
Camellia Lane	Links Camellia Garden with Central Path	E
Fountain Walk	Parallel to Central Path	E
Island Way	Links Central Path to Fountain Walk	E
Azalea Lane	Links Central Path to Fountain Walk	E
Shady Lane	Links Camellia Garden with to start of Curator's Avenue	E
Kiosk Lane	Links Camellia Garden with to middle of Curator's Avenue	E

0 10 20 30 40 50m

Scale 1:1000 Refer to Legend for Compartment plans on page 40.

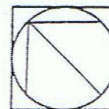
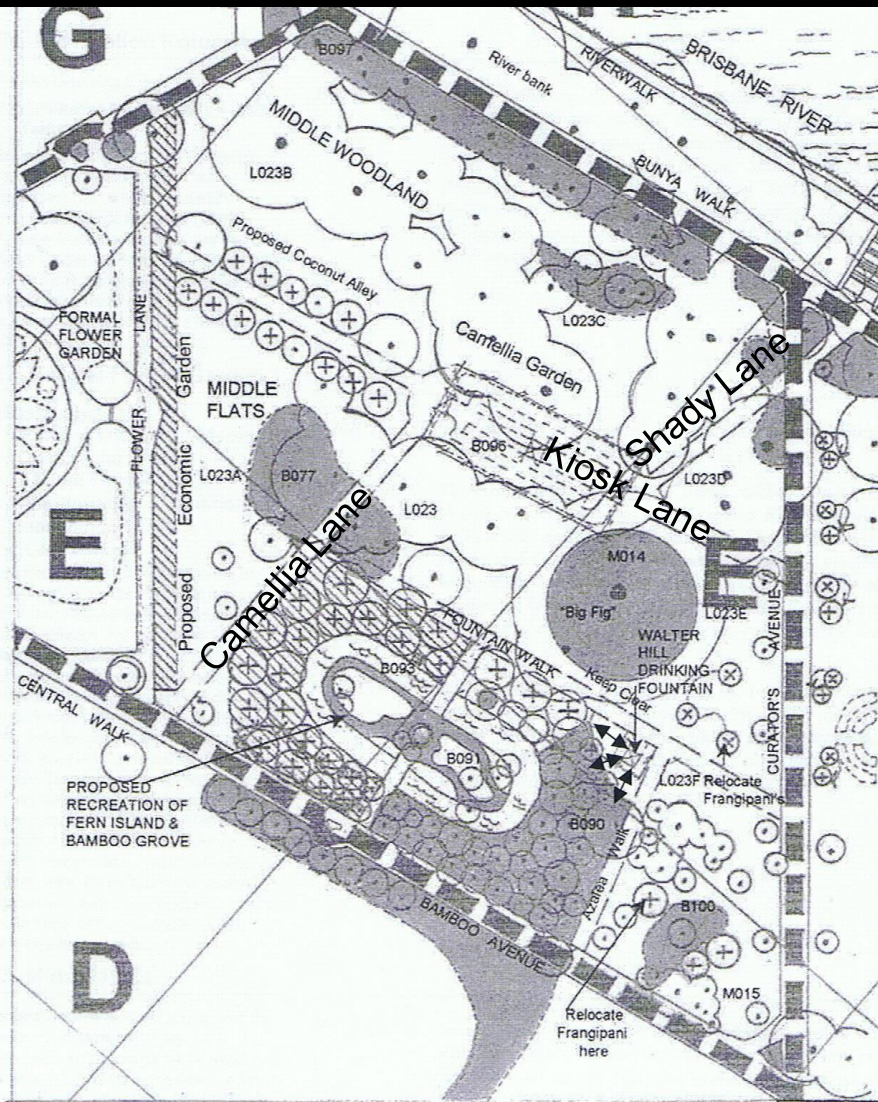

Figure 3.8 PLAN of COMPARTMENT E: Middle Gardens – Part 1 of 2

Sim 2005:58



- |               |                                                          |   |
|---------------|----------------------------------------------------------|---|
| Coconut Alley | Links Camellia Garden with Flower Lane                   | E |
| Camellia Lane | Links Camellia Garden with Central Path                  | E |
| Fountain Walk | Parallel to Central Path                                 | E |
| Island Way    | Links Central Path to Fountain Walk                      | E |
| Azalea Walk   | Links Central Path to Fountain Walk                      | E |
| Shady Lane    | Links Camellia Garden with to start of Curator's Avenue  | E |
| Kiosk Lane    | Links Camellia Garden with to middle of Curator's Avenue | E |

Sim 2005:59

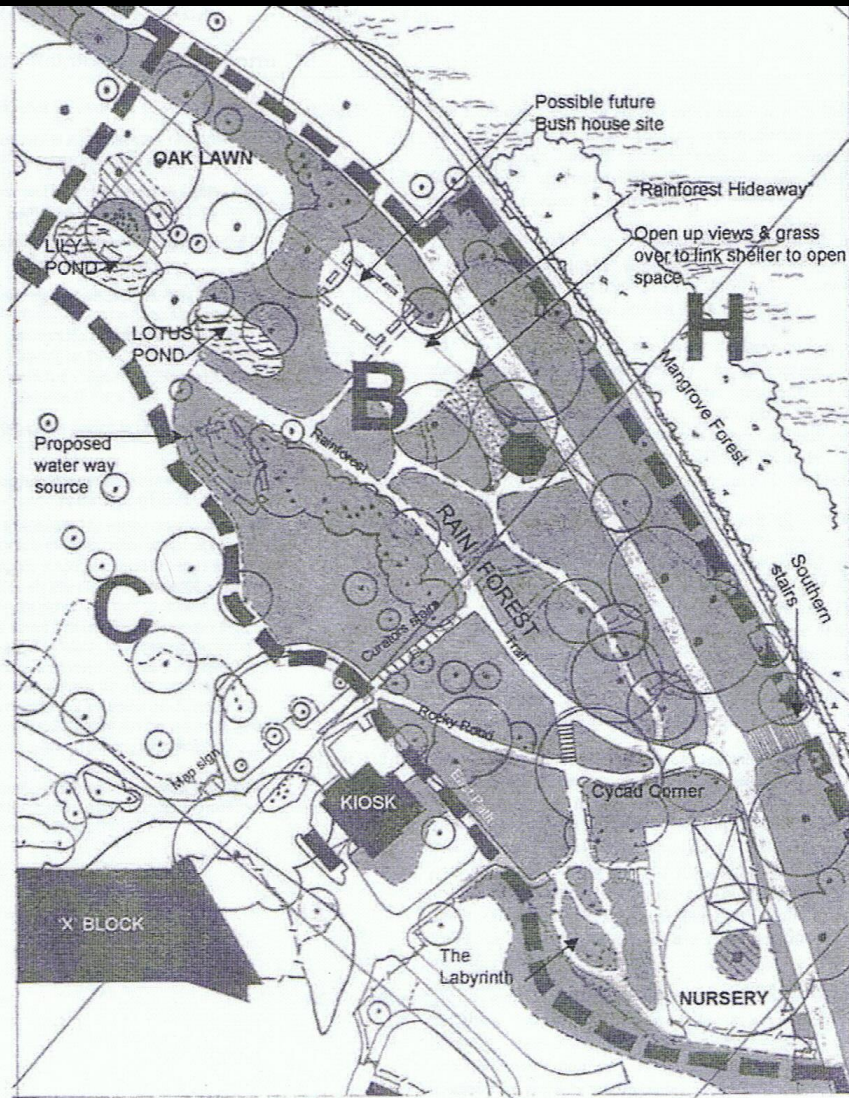

0 10 20 30 40 50m

Scale 1:1000 Refer to Legend for Compartment plans on page 40.

Scale 1:1000

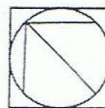
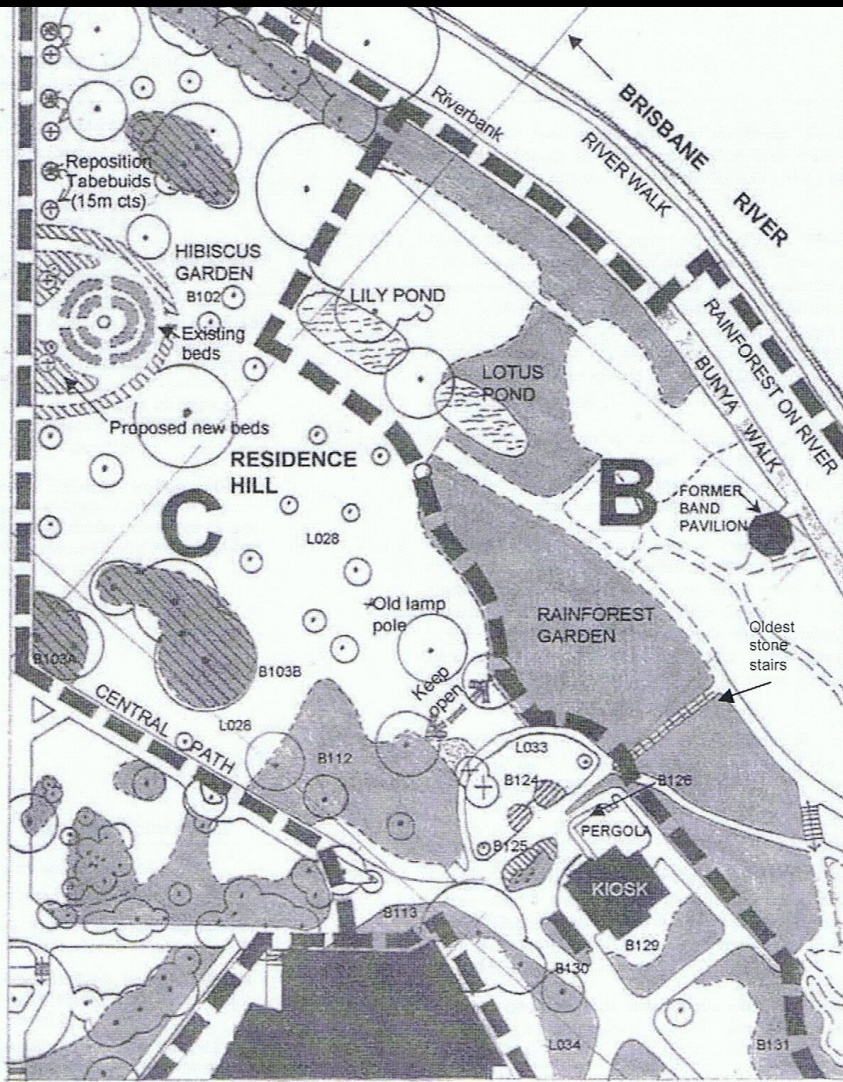

Figure 3.4 PLAN of COMPARTMENT B: Rainforest area

Rainforest Track	Main track in Rainforest Garden	B
Macadamia Trail	Rough track between Bunya Walk & Rainforest Track	B
Rocky Road	Internal Rainforest Garden Pathway	B
Curators' Stairs	From Former Curator's House to	B
The Labyrinth	Internal Rainforest Garden pathway complex, behind Nursery	B

Sim 2005:42



0 10 20 30 40 50m

Scale 1:1000

Refer to Legend for Compartment plans on page 40.

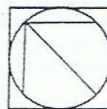

Figure 3.5 PLAN of COMPARTMENT C: Kiosk and adjacent areas

The Verge	Edges Former Curator's House Front	C
North Path	In front of Former Curator's House	C
West Path	Beside Former Curator's House	C
East Path	Beside Former Curator's House	C
South Path	Behind Former Curator's House	C

Sim 2005:47